

Oggie Grip Installation Instructions

Oggie Grip installs in the same manner as a wood end plug. Be sure to read and adhere to all safety guidelines when using power or hand tools before proceeding. Children installing grip should always seek adult supervision before attempting to install.

Important Note: Oggie Products manufactures Adult grips to fit Adult/Senior sticks only, and Jr/Intermediate grips to fit Jr and Intermediate sticks only. Be certain you purchased the correct grip for your stick before proceeding.

Tools Required: Heat Gun (recommended) or Hair Dryer
(Optional) White Cloth Hockey Tape

Installation: If stick is required to be cut: Hacksaw Pencil Miter Box (optional)
Medium to coarse file

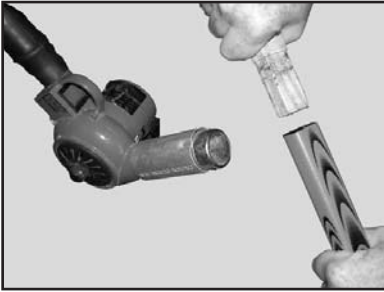

Step 1

Remove wood or composite end plug utilizing heat gun or hair dryer. If stick has plastic end plug, pop out with screwdriver.



Step 2

Hold both stick and grip vertically and adjust grip end to proper length. Mark a cut-line onto stick at bottom of rubber grip section.

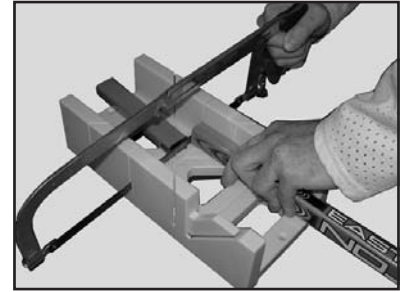

Step 3

Cut stick at mark line. To aid in making straight cuts, we suggest using a miter box.

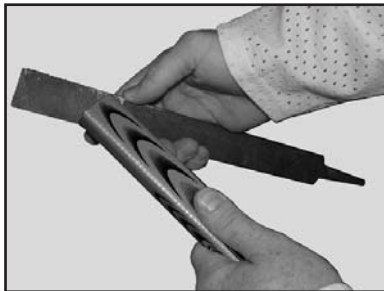

Step 4

Use a file to smooth out any frayed areas on the stick shaft caused by cutting. Roughen inside of stick shaft with file to allow a better bond.

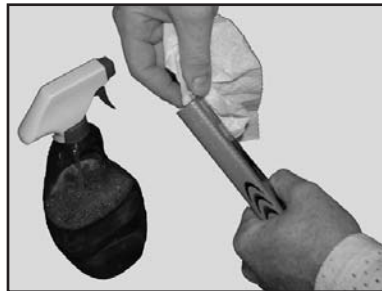

Step 5

Clean inside of stick shaft thoroughly. Be careful not to get splinters from composite stick.



Step 6

Heat grip and stick with heat gun or hair dryer. Insert grip with proper orientation until firmly seated against grip stop while glue is still melted (Figure A). Set aside for approximately 10 minutes undisturbed for hot melt to set up completely. Peel off excess glue. Stick and grip are now ready for use.

 **Hat Trick Tip**
If your grip becomes loose after installation, remove grip and place strips of cloth hockey tape onto the insert area of the grip along with additional hot melt glue (supplied) and re-install. Doing this will tighten up any gaps between the stick and the grip providing a nice tight fit.

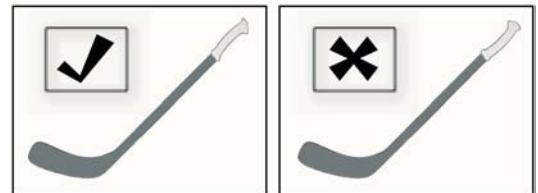

Figure A

Removal / Reinstallation:

Heat stick area with heat gun while at the same time pulling on grip. Grip should pull out when hot melt is sufficiently heated. Do not overheat. It is recommended that an additional glue stick be used for re-installation.

If you have problems with installation log on to <http://www.oggiegrip.com/contact/> or call Oggie customer service at (888) 832-2047.